

## Wall mounting appliance inlet - with external fixing



| Product description       |   |
|---------------------------|---|
| BALS-Prd.-Nr              | 24405                                       |
| EAN                       | 4024941244053                               |
| Product category          | wall mounting appliance inlet QUICK-CONNECT |
| Current                   | 32A   |
| Number of poles           | 4p  |
| Arrangement of phases     | 3P+PE                                       |
| Position of earth contact | 6 h   |
| Voltage                   | 380 - 415V~                                 |
| Frequency                 | 50/60Hz                                     |

| Product description    |   |
|------------------------|---|
| Protection degree      | IP44  |
| Colour code            | red RAL 3000  |
| Colour of appliance    | Housing top red RAL 3000, Collar red RAL 3000, Housing bottom grey RAL 7035 |
| Connection design      | screwless spring-clamp technology   |
| Maximum conductor size | 6,0 qmm   |
| Cable entry            | top entry M25   |
| Height                 | 133mm   |
| Width                  | 94mm  |
| Depth                  | 87mm  |
| Dimension of enclosure | 92x94 mm (HxW)  |
| Material of enclosure  | Polyamide   |
| Contacts               | the contact carrier is made of polyamide, the contacts are brass            |

| Additional technical properties |   |
|---------------------------------|---|
|                                 | The cable entry is one at top open and one at bottom closed |

| Logistics data |                  |
|----------------|------------------|
| Weight/pcs     | 0.249 kg / Piece |
| Packaging      | Bag              |
| Content amount | 1 ST             |
| EAN            | 4024941244053    |

| Logistics data |               |
|----------------|---------------|
| Length         | 87 mm         |
| Width          | 94 mm         |
| Height         | 133 mm        |
| Weight         | 0.25 kg       |
| Volume         | 1,087.674 ccm |
| Packaging      | Carton        |
| Content amount | 10 ST         |
| EAN            | 4024941958158 |
| Length         | 325 mm        |
| Width          | 217 mm        |
| Height         | 210 mm        |
| Weight         | 2.696 kg      |
| Volume         | 13,588.4 ccm  |

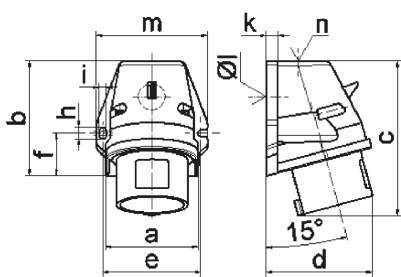

5 MB 44

| Ampere                     | 16    | 16    | 16    | 32    | 32    | 32    |
|----------------------------|-------|-------|-------|-------|-------|-------|
| Polzahl                    | 3     | 4     | 5     | 3     | 4     | 5     |
| a                          | 59,5  | 72,4  | 72,4  | 79,1  | 79,1  | 79,1  |
| b                          | 90,0  | 90,0  | 90,0  | 92,0  | 92,0  | 92,0  |
| c                          | 120,0 | 120,0 | 122,0 | 134,0 | 134,0 | 134,0 |
| d                          | 72,0  | 84,0  | 84,0  | 89,0  | 89,0  | 89,0  |
| e                          | 62,0  | 77,0  | 77,0  | 84,0  | 84,0  | 84,0  |
| f                          | 33,5  | 33,5  | 33,5  | 30,0  | 30,0  | 30,0  |
| h                          | 9,0   | 9,0   | 9,0   | 9,0   | 9,0   | 9,0   |
| i                          | 5,5   | 5,5   | 5,5   | 5,5   | 5,5   | 5,5   |
| k                          | 8,0   | 9,0   | 9,0   | 9,0   | 9,0   | 9,0   |
| l Ø                        | 21,0  | 21,0  | 21,0  | 21,0  | 21,0  | 21,0  |
| m                          | 72,0  | 87,0  | 87,0  | 94,0  | 94,0  | 94,0  |
| n                          | M20   | M25   | M25   | M25   | M25   | M25   |
| Leiter mm <sup>2</sup> min | 1     | 1     | 1     | 2,5   | 2,5   | 2,5   |
| Leiter mm <sup>2</sup> max | 2,5   | 2,5   | 2,5   | 6     | 6     | 6     |